

River Courses.

- South - 16.1
 - S 20 E. 26.
 - S 47 1/2 E 42.
 - S 27 E. 32.
 - S 5 1/2 W. 24.
 - S 35 W. 28
 - S 63 1/2 W. 22.
 - S 72 1/2 W 24.
 - S 32 1/2 W. 29.4.
- 243, 5 P^s

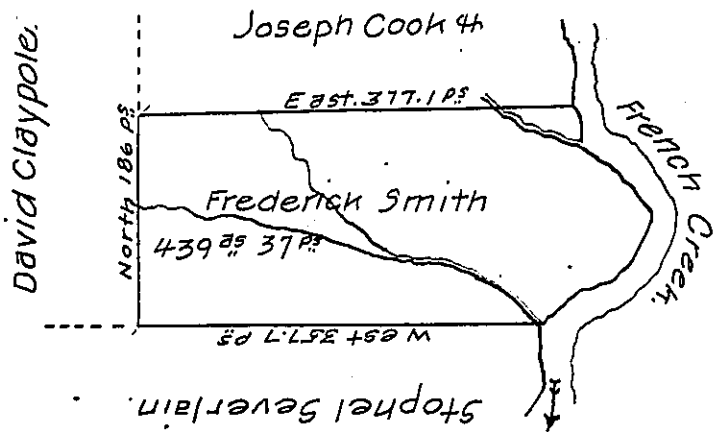

Situate on the west side of and adjoining French Creek in Allegheny County ~~county~~ containing 439 acres 37 perches and allowance of six per cent for Roads &c. Surveyed the 13th day of October 1794, in pursuance of a Warrant of 400^{ac} granted to Frederick Smith dated 13th day of April 1792.

Crawford County ss., Deputy surveyors, office -

I do hereby certify that the above is a true Copy of a survey in the name of Frederick Smith as appears of Record, in survey Book A Page (142) Remaining in my office as witness my hand this 8th day of September, 1819.

James Herrington, D^{YS}r

To Jacob Spangler, Esquire Surveyor, -
General of the Land Office of Pennsylvania. }

IN TESTIMONY that the above is a copy of the original remaining on file in the Department of Internal Affairs of Pennsylvania, made conformably to an Act of Assembly approved the 16th day of February, 1833, I have hereunto set my Hand and caused the Seal of said Department to be affixed at Harrisburg, this twenty seventh day of May, 1907.

Henry Houck.
Secretary of Internal Affairs.